



## BHAVISHA PROPERTIES

 [casalife@bhavishahomes.com](mailto:casalife@bhavishahomes.com)

 [www.bhavishahomes.com](http://www.bhavishahomes.com)

 CASALIFE BY BHAVISHA PROPERTIES  
SURVEY NO 130 , SARJAPUR MAIN RD,  
V. KALLAHALLI, BENGALURU, KARNATAKA- 562125

THE SYMPHONY OF  
**BHAVISHA HOMES**  
PRESENTING

**CASA  
LIFE**



**RERA NO:**  
PRM/KA/RERA/1251/308  
/PR/220424/006822



# CASA LIFE

Introducing Casa Life Villas!  
The epitome of luxurious living

Nestled in fastest developing locality of Bangalore, these villas offer unparalleled elegance and modern comforts. With exquisite architecture. It emphasizes functionality, aesthetics, and comfort while integrating modern technologies and sustainable practices. Key elements include efficient spatial planning, attention to lighting and ventilation. Casa Life Villas is a blend of creativity with practicality, creating spaces that feel personal, welcoming, and harmonious within their surroundings.



## EXQUISITE ARCHITECTURE

The epitome of luxurious living. These villas offer unparalleled elegance and modern comforts. With exquisite architecture and top-notch amenities, Casa Life Villas are designed to provide a serene and sophisticated lifestyle.





# MASTER PLAN



## LEGENDS

1. Cricket practice net
2. Badminton/ Volleyball Court
3. Swing Lawn
4. Arrival Square
5. Mini Golf Course
6. Tree - Court/ Forest tree lined
7. Pet Park
8. Amphitheater
9. Skating Rink
10. Sand Pit with play Equipment
11. Giant Chess
12. Water falls
13. Rock climbing wall
14. Trampoline
15. Rain dance with music
16. Sundeck
17. Swimming pool & kids pool with change room & locker
18. Hydro Pneumatic water supply system
19. Electric car charging bay
20. Laundry - Ironing shop
21. STP
22. Transformer yard
23. Buddha feature
24. Fountain square
25. Entrance arch
26. Security room
27. Senior's corner
28. Guided nature walks
29. Kids drop-off zone/ School - pickup bay
30. Divider line

## CLUB HOUSE

- Multipurpose party hall
- Business center
- Co working space/ conference
- Cafeteria
- Gym/ Aerobatics (Interactive Gym, Cross Fit Corner, boxing corner, weight lifting & dance floor)
- Yoga/ Meditation Area
- Association/ Maintenance office/ Management office
- Table tennis
- Board games



# MASTER PLAN



# SERENE LIFE

Dive into the refreshing swimming pools, enjoy leisurely walks in beautifully landscaped gardens, and unwind in the exclusive clubhouse. With meticulous attention to detail, Casa Life Villas redefine the standards of modern living. Experience a lifestyle of convenience, comfort, and indulgence with our exceptional amenities.





# VILLA NO-1 EAST FACING

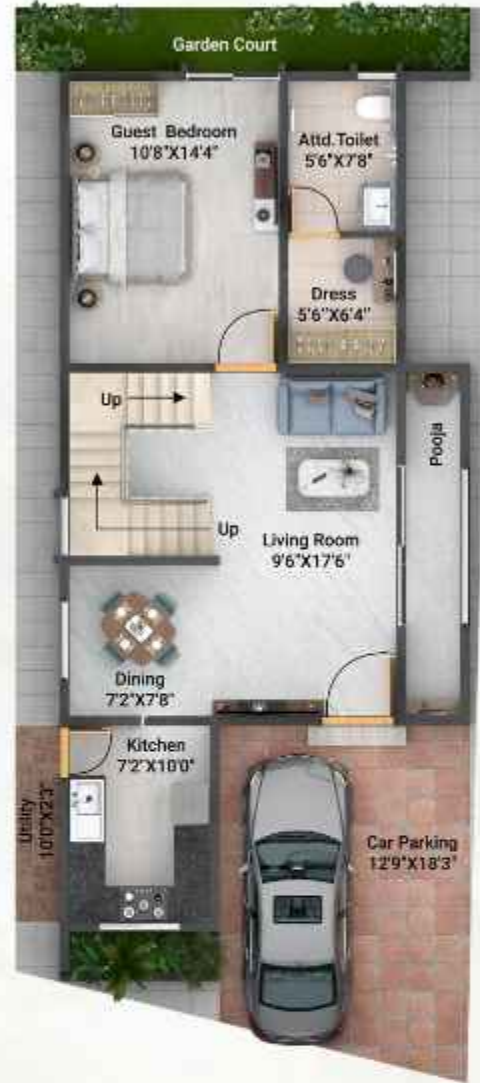

GROUND FLOOR



FIRST FLOOR



TERRACE

Ground Floor Area - 937 sq ft  
First Floor Area - 916 sq ft  
Terrace Floor Area - 562 sq ft  
Total Builtup Area- 2415 sq ft



# VILLA NO- 2 EAST FACING



GROUND FLOOR



FIRST FLOOR



TERRACE

Ground Floor Area - 931 sq ft  
First Floor Area - 905 sq ft  
Terrace Floor Area - 639 sq ft  
Total Builtup Area- 2475 sq ft



# VILLA NO- 3 EAST FACING



GROUND FLOOR



FIRST FLOOR



TERRACE

Ground Floor Area - 920 sq ft  
First Floor Area - 890 sq ft  
Terrace Floor Area - 605 sq ft  
Total Builtup Area- 2415 sq ft





# VILLA NO- 4 EAST FACING



GROUND FLOOR



FIRST FLOOR



TERRACE

Ground Floor Area - 714 sq ft  
First Floor Area - 695 sq ft  
Terrace Floor Area - 489 sq ft  
Total Builtup Area- 1898 sq ft



# VILLA NO- 5,6,7,14,15,22,23,38,39,40 WEST FACING



GROUND FLOOR



FIRST FLOOR



TERRACE

Ground Floor Area - 1046 sq ft  
First Floor Area - 1018 sq ft  
Terrace Floor Area - 783 sq ft  
Total Builtup Area- 2847 sq ft



# VILLA NO- 8 WEST FACING



GROUND FLOOR



FIRST FLOOR



TERRACE

Ground Floor Area - 707 sq ft  
First Floor Area - 707 sq ft  
Terrace Floor Area - 540 sq ft  
Total Builtup Area- 1954 sq ft



# VILLA NO- 9 EAST FACING



GROUND FLOOR



FIRST FLOOR



TERRACE

Ground Floor Area - 913 sq ft  
First Floor Area - 891 sq ft  
Terrace Floor Area - 602 sq ft  
Total Builtup Area- 2406 sq ft



# VILLA NO- 10,11,12,17,18,19 EAST FACING



GROUND FLOOR



FIRST FLOOR



TERRACE

Ground Floor Area - 1010 sq ft  
First Floor Area - 991 sq ft  
Terrace Floor Area - 663 sq ft  
Total Builtup Area- 2664 sq ft



# VILLA NO-13 WEST FACING



GROUND FLOOR

FIRST FLOOR

TERRACE

Ground Floor Area - 1132 sq ft  
First Floor Area - 1105 sq ft  
Terrace Floor Area - 847 sq ft  
Total Builtup Area- 3084 sq ft



# VILLA NO-16 WEST FACING



GROUND FLOOR



FIRST FLOOR



TERRACE

Ground Floor Area - 983 sq ft  
First Floor Area - 954 sq ft  
Terrace Floor Area - 737 sq ft  
Total Builtup Area- 2674 sq ft



# VILLA NO- 20 EAST FACING



GROUND FLOOR



FIRST FLOOR



TERRACE

Ground Floor Area - 1257 sq ft  
First Floor Area - 1241 sq ft  
Terrace Floor Area - 823 sq ft  
Total Builtup Area- 3321 sq ft





# VILLA NO- 21 WEST FACING



GROUND FLOOR



FIRST FLOOR



TERRACE

Ground Floor Area - 1371 sq ft  
First Floor Area - 1346 sq ft  
Terrace Floor Area - 1026 sq ft  
**Total Builtup Area- 3743 sq ft**



# VILLA NO- 24 WEST FACING



GROUND FLOOR



FIRST FLOOR



TERRACE

Ground Floor Area - 1087 sq ft  
 First Floor Area - 1059 sq ft  
 Terrace Floor Area - 813 sq ft  
**Total Builtup Area- 2959 sq ft**



# VILLA NO- 25 EAST FACING



GROUND FLOOR



FIRST FLOOR



TERRACE

Ground Floor Area - 808 sq ft  
First Floor Area - 813 sq ft  
Terrace Floor Area - 516 sq ft  
Total Builtup Area- 2137 sq ft



# VILLA NO- 26 EAST FACING



GROUND FLOOR



FIRST FLOOR



TERRACE

Ground Floor Area - 842 sq ft  
First Floor Area - 847 sq ft  
Terrace Floor Area - 540 sq ft  
Total Builtup Area- 2229 sq ft



# VILLA NO- 27 EAST FACING



GROUND FLOOR



FIRST FLOOR



TERRACE

Ground Floor Area - 866 sq ft  
First Floor Area - 872 sq ft  
Terrace Floor Area - 568 sq ft  
Total Builtup Area- 2306 sq ft



# VILLA NO- 28 EAST FACING



GROUND FLOOR



FIRST FLOOR



TERRACE

Ground Floor Area - 1327 sq ft  
First Floor Area - 1358 sq ft  
Terrace Floor Area - 919 sq ft  
**Total Builtup Area- 3604 sq ft**



# VILLA NO- 29 NORTH FACING



GROUND FLOOR



FIRST FLOOR



TERRACE

Ground Floor Area - 1108 sq ft  
First Floor Area - 1071 sq ft  
Terrace Floor Area - 906 sq ft  
Total Builtup Area- 3085 sq ft



# VILLA NO- 30 NORTH FACING



GROUND FLOOR



FIRST FLOOR



TERRACE

Ground Floor Area - 1151 sq ft  
First Floor Area - 1115 sq ft  
Terrace Floor Area - 938 sq ft  
**Total Builtup Area- 3204 sq ft**





# VILLA NO- 31,32,33 WEST FACING



GROUND FLOOR



FIRST FLOOR



TERRACE

Ground Floor Area - 1304 sq ft  
First Floor Area - 1268 sq ft  
Terrace Floor Area - 985 sq ft  
Total Builtup Area- 3557 sq ft



# VILLA NO- 34 WEST FACING



GROUND FLOOR



FIRST FLOOR



TERRACE

Ground Floor Area - 1280 sq ft  
First Floor Area - 1243 sq ft  
Terrace Floor Area - 985 sq ft  
**Total Builtup Area- 3508 sq ft**



# VILLA NO- 35 WEST FACING



GROUND FLOOR



FIRST FLOOR



TERRACE

Ground Floor Area - 1252 sq ft  
First Floor Area - 1215 sq ft  
Terrace Floor Area - 985 sq ft  
Total Builtup Area- 3452 sq ft



# VILLA NO- 36 WEST FACING



GROUND FLOOR



FIRST FLOOR



TERRACE

Ground Floor Area - 1130 sq ft  
First Floor Area - 1112 sq ft  
Terrace Floor Area - 839 sq ft  
**Total Builtup Area- 3081 sq ft**



# VILLA NO- 37 WEST FACING



GROUND FLOOR



FIRST FLOOR



TERRACE

Ground Floor Area - 1125 sq ft  
First Floor Area - 1098 sq ft  
Terrace Floor Area - 842 sq ft  
Total Builtup Area- 3065 sq ft



# VILLA NO- 41 WEST FACING



GROUND FLOOR



FIRST FLOOR



TERRACE

Ground Floor Area - 951 sq ft  
First Floor Area - 921 sq ft  
Terrace Floor Area - 713 sq ft  
**Total Builtup Area- 2585 sq ft**



# VILLA NO- 42 EAST FACING



GROUND FLOOR



FIRST FLOOR



TERRACE

Ground Floor Area - 1230 sq ft  
First Floor Area - 1274 sq ft  
Terrace Floor Area - 873 sq ft  
Total Builtup Area- 3377 sq ft



# VILLA NO- 43,44,45,46,47,48 EAST FACING



GROUND FLOOR



FIRST FLOOR



TERRACE

Ground Floor Area - 1205 sq ft  
First Floor Area - 1189 sq ft  
Terrace Floor Area - 849 sq ft  
Total Builtup Area- 3243 sq ft





# VILLA NO- 49,50,51,52,53 EAST FACING

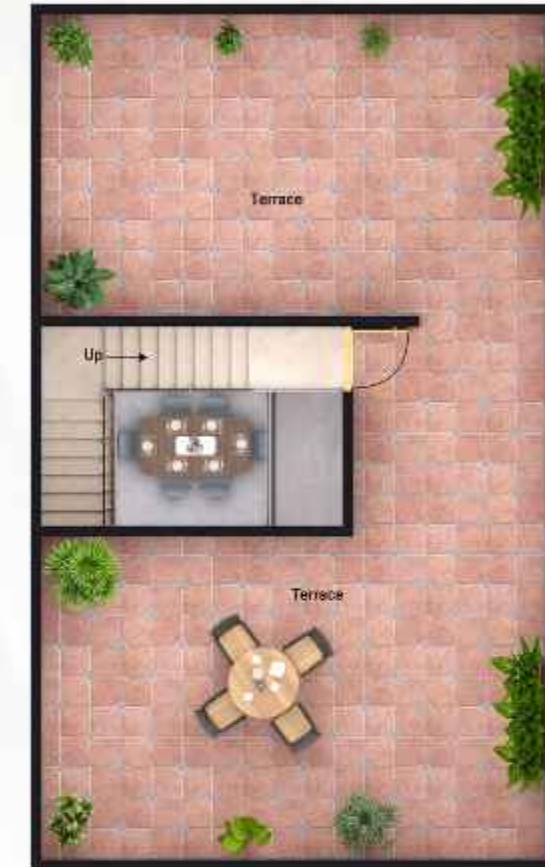

GROUND FLOOR



FIRST FLOOR



SECOND FLOOR



TERRACE

Ground Floor Area - 1205 sq ft  
First Floor Area - 1170 sq ft  
Second Floor Area - 1280 sq ft  
Terrace Floor Area - 185 sq ft  
**Total Builtup Area- 3840 sq ft**



# VILLA NO- 54 EAST FACING



GROUND FLOOR



FIRST FLOOR



SECOND FLOOR



TERRACE

Ground Floor Area - 1104 sq ft  
First Floor Area - 1064 sq ft  
Second Floor Area - 1177 sq ft  
Terrace Floor Area - 185 sq ft  
**Total Builtup Area- 3530 sq ft**



## YOUR GATEWAY TO MODERN AMENITIES

- Entrance Arch
- 24/7 Security System & Camera Surveillance System
- Hydro Pneumatic water supply system
- Luxury 4 BHK Smart Villa - Private Garden (optional), Home theater Room
- Club House
- Multipurpose Party Hall
- Business center
- Co working Space /Conference
- Cafeteria
- Gym/Aerobatics (Interactive Gym, Cross Fit Corner, Boxing corner, Weight lifting & Dance Floor)
- Yoga/Meditation Area (Inside @ Gym /Multipurpose Hall)
- Association/maintenance office/management office @ Club House
- Table Tennis
- Board games
- Swimming Pool
- Kids Pool @ Swimming Pool with Change Room with Lockers
- Rain dance with Music
- Badminton court/Volley Ball Court (2 in 1)
- Skating
- Cricket Net - Practice Area
- Rock Climbing Wall
- Laundry -ironing Shop
- Mini Shopping /Grocery Shopping /Daily Needs Shop
- Trampoline
- Swing Lawn
- Sand Pit with outdoor Play Equipments (15 Games)
- Giant Chess
- Kids Drop-off - Zone/ School - Pickup Bay
- Pet Park
- Arrival Square
- Tree - Court/Forest tree Lined
- Environmental Sustainability Features (Solar Panels, Rainwater Harvesting)
- Digital - Library or Reading Room
- Mini golf Course
- Backup Power generator with Automatic Transfer Switch - Common area
- On - Site Recycling and Waste Management program (STP)
- Transformer Yard
- Guided Nature Walks
- Sun Deck
- Fountain Square
- Divider Line
- Electric car Charging Bay
- Amphitheater





## SPECIFICATIONS

- Vastu Complaint Structure
- RCC Framed Structure with solid block masonry
- 6" Thick External & 4" Thick Internal Wall
- Covered Car Parking

### DOORS

- MAIN DOOR will be teak panel door with teak wood frame or Engineering wood door
- BEDROOM & OTHER DOORS – Flush doors with Hard Wood frame or Engineering wood door

### WINDOWS

- UPVC Windows and Balcony doors
- MS safety grills with enamel paint for windows
- Staircase & Balcony railing Stainless Steel

### KITCHEN

- GRANITE COUNTERS with Stainless Steel Single Bowl Sink with drainboard
- DECORATIVE CERAMIC TILE Dado up to 2'0" height
- EXHAUST FAN provision for Hob
- WATER PURIFIER Provision

### BATHROOMS

- SANITARY FITTINGS of Toto / Kohler or Equivalent make
- CP FITTINGS of Toto / Kohler or equivalent make
- CERAMIC TILE cladding up to 7'0" height
- GEYSER point & Exhaust fan provision
- SUSPENDED PIPELINES in toilets concealed

### FLOORING

- Vitrified Flooring Tiles 2'6 X 5'3" for Kitchen, guest Bedroom, bedroom 3 and home theatre etc.
- Wooden Flooring for Master bedroom and Children bedroom
- All living and staircase area with marble
- Antiskid Flooring for Toilets and Balcony

### ELECTRICAL

- Anchor Panasonic/ Legrand Equivalent smart scava switches
- MODULAR SWITCHES with ISI Standard Cables
- AC point provision for the Master Bedroom
- 5KW power supply

### PAINTING

Emulsion for internal walls and Weather proof paint for Exterior

## LOCATION MAP

